



1-Up Series | Grantsville, UT  
HIGHLANDS COMMUNITY  
801.784.9100 | updwell.com



# NEWPORT

2 bed | 2 bath | 2-car  
2488 Sq Ft • Garage 436 Sq Ft



FARMHOUSE



CRAFTSMAN

Equal Housing Opportunity. All home and community information, including but not limited to pricing, included features, terms, availability, and amenities, is subject to change at any time without prior notice or obligation. All renderings, photographs, colors, features, and dimensions are for illustrative purposes only. Square footage is approximate. For complete details, please consult a sales representative. [3/25/2026]



**MAIN FLOOR**

1244 Sq Ft



**BASEMENT (UNFINISHED)**

1244 Sq Ft



**OPTIONS**

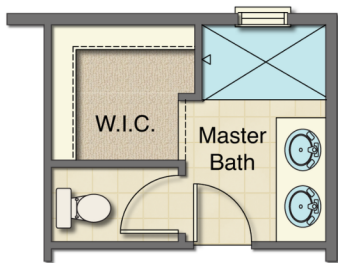

Master Bath

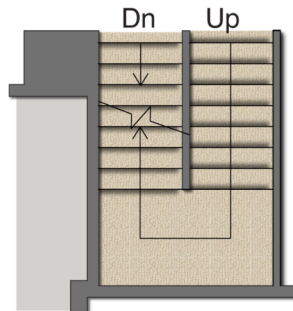

Alternate Stairs

**OPTIONAL BASEMENT APARTMENT**

Accessory Dwelling Unit

